

# Installation and Operational Instructions for ROBA-stop® brakes / hand release Sizes 3 – 9

(B.1110.5.GB)

**Please read these Operational Instructions carefully and follow them accordingly!**

Ignoring these Instructions may lead to malfunctions or to brake failure, resulting in damage to other parts.

## Please Observe!

These Operational Instructions may only be used together with the specific Installation and Operational Instructions, depending on Type. If required, you can download them on our website [www.mayr.de](http://www.mayr.de) or order them by mail.

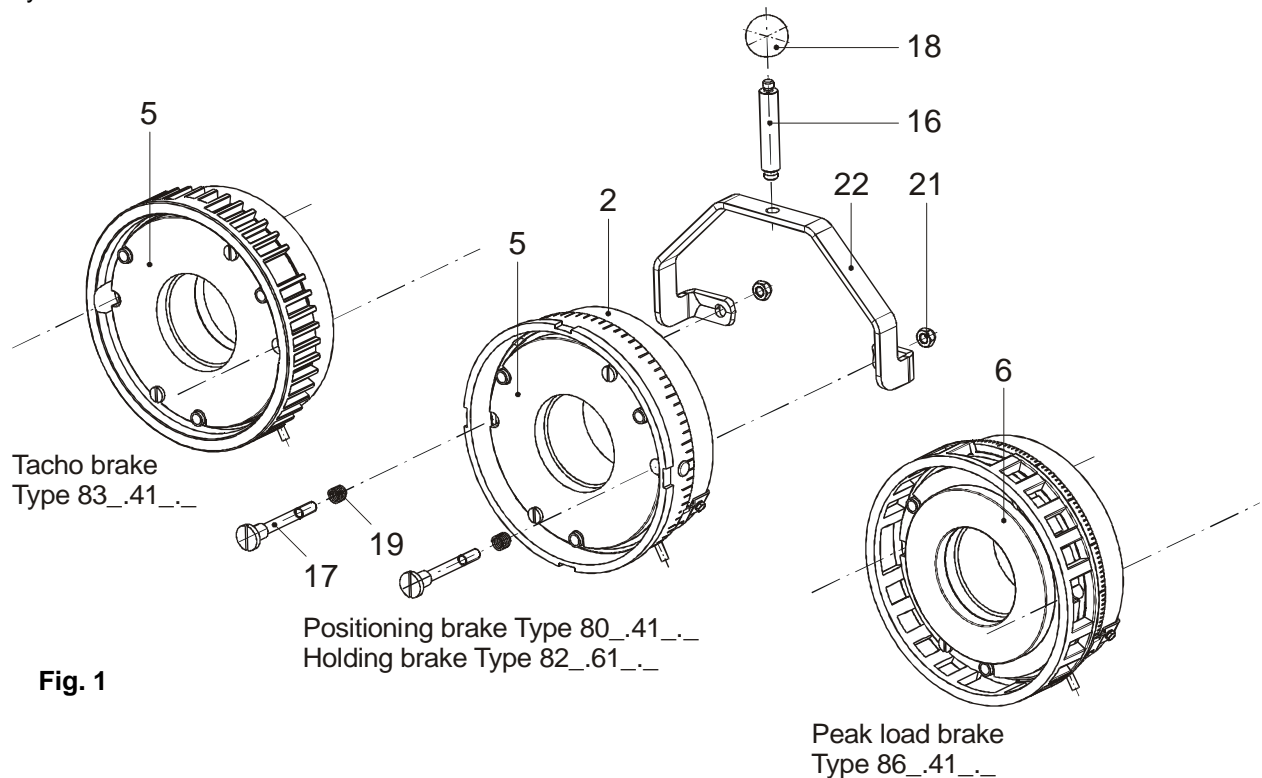

Fig. 1

## Parts List

(Only use mayr® original parts)

Item	Name
2	Coil carrier assembly
5	Armature disk
6	Fast acting shear connector
16	Threaded bolt
17	Restoring bolt
18	Spherical button
19	Restoring spring
21	Self-locking nut
22	Hand release bracket
31	Distance ring

## Installation Process:

1. Screw the threaded bolt (16) into the hand release bracket (22), screw the spherical button (18) onto the threaded bolt (16). Secure with Loctite 243 in both cases.
2. Remove the plastic plug from the bores on the rear side of the coil carrier.
3. Push restoring springs (19) onto the restoring bolt (17).
4. Push the restoring bolt (17) through the recesses in the armature disk (5) or the fast acting shear connector (6) and through the bores in the coil carrier (2).
5. Screw the hand release bracket (22) with the self-locking nuts (21) to the restoring bolt (17).
6. Tighten the self-locking nuts (21) evenly until reaching the required adjustment dimension (see section "Adjustment" on page 2). Adjustment takes place in a de-energised state.

## Installation

The hand release can be mounted onto the positioning brake, the holding brake (sizes 3 – 8), the tacho brake or the peak load brake, expect Type 804.41\_.\_.

Before installation, the brake must be dismantled.

The installation process is the same for all brake Types.

**Please Observe:** The adjustment dimension varies, dependent on the brake Type and the brake size. Incorrect adjustment affects the function of the brake or the hand release.

# Installation and Operational Instructions for ROBA-stop® brakes / hand release Sizes 3 – 9

(B.1110.5.GB)

## Adjustment

### Positioning brake / Holding brake:

Types 80\_41\_ and 82\_61\_

For the adjustment dimension X (air gap between armature disk (5) and coil carrier (2)), see Table 1 and Fig. 2. Measurement of the adjustment dimension takes place via the three inspection holes on the circumference of the distance ring (31).

The holes are sealed with plastic plugs.

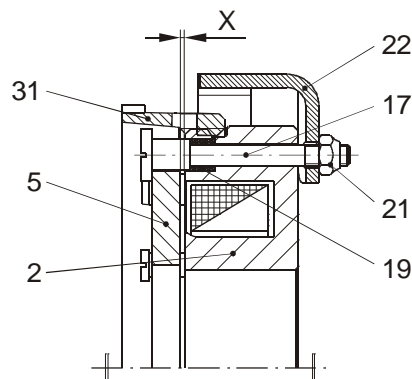

Fig. 2

Table 1

ROBA-stop®	Size	3	4	5	6	7	8	9
Adjustment dimension X	[mm]	1,0	1,1	1,2	1,6	1,4	1,5	1,5

### Peak load brake:

Types 863.41\_ and 866.41\_

For the adjustment dimension X (air gap between armature disk (6) and coil carrier (2)), see Table 2 and Fig. 3. Measurement of the adjustment dimension takes place via the open distance ring (31).

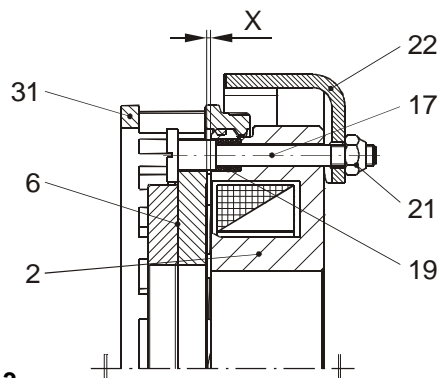

Fig. 3

Table 2

ROBA-stop®	Size	7	8	9
Adjustment dimension X	[mm]	1,4	1,5	1,5

### Tacho brake:

Type 83\_41\_

For the adjustment dimension X<sub>2</sub>, please see Table 3 and Fig. 4. The distance ring (31) is not adjustable and does not have any inspection holes for the air gap between the armature disk (5) and the coil carrier (2). Therefore, the dimension from the system surface of the distance ring (31) to the facing side of the armature disk (5) is adjusted on this brake Type.

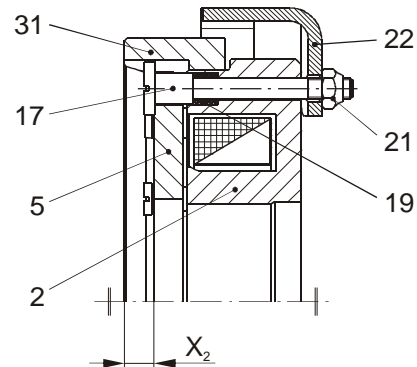

Fig. 4

Table 3

ROBA-stop®	Size	3	4	5	6	7	8	9
Adjustment dimension X <sub>2</sub>	[mm]	4,2	5,0	6,0	7,4	9,8	11,2	13,8